

# TOWN OF LA CONNER ZONING MAP

## LEGEND:

- C** COMMERCIAL
- CT** COMMERCIAL TRANSITION
- I** INDUSTRIAL
- P** PUBLIC USE
- R** RESIDENTIAL
- A** AGRICULTURAL DISTRICT (SKAGIT COUNTY)
- M** INDUSTRIAL DISTRICT (SKAGIT COUNTY)
- TOWN LIMITS
- HISTORIC PRESERVATION DISTRICT OVERLAY ZONE
- ZONING BOUNDARY LINE
- 200' SHORELINE SETBACK
- SKAGIT COUNTY ZONING BOUNDARIES (APPROX.)
- NEW URBAN GROWTH AREA

## AREA BREAKDOWN:

- 58.0 ACRES COMMERCIAL
- 4.3 ACRES COMMERCIAL TRANSITION
- 29.9 ACRES INDUSTRIAL
- 55.2 ACRES PUBLIC USE
- 
- 107.7 ACRES RESIDENTIAL
- 
- 255.1 ACRES TOTAL TOWN LIMITS
- 14 ACRES URBAN GROWTH AREA
- 51.5 ACRES HISTORIC PRESERVATION DISTRICT OVERLAY ZONE

OFFICIAL ZONING MAP FOR THE TOWN OF LA CONNER. CERTIFIED AND ADOPTED BY ORDINANCE NO. 979 ON DECEMBER 12, 2006

APPROXIMATE ORDINARY HIGH WATER MARK (OHWM) ELEVATION = 5.0

APPROXIMATE 200 FOOT SETBACK LINE FROM ORDINARY HIGH WATER MARK (OHWM)

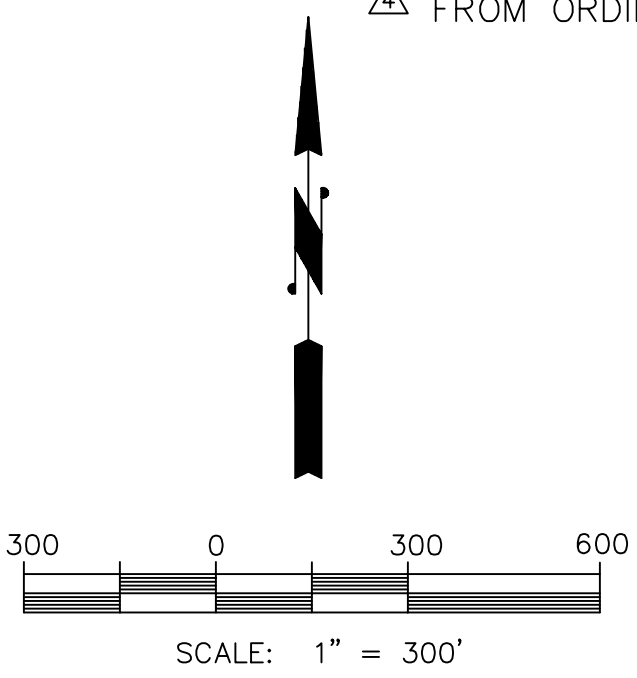

NOTE: EXTREME HIGH TIDE (EHT) ELEVATION = 8.0  
EXTREME LOW TIDE (ELT) ELEVATION = -10.5

APPROXIMATE MEAN SEA LEVEL (MSL) MSL ELEVATION = 00.0

BOAT LAUNCH

RAINBOW BRIDGE

SHERMAN AVE.

CONNER WAY

BOYER

PARKWAY

PARK ST.

FINLEY LN. (PRIVATE)

MAPLE AVE.

HILL ST.

DOUGLAS ST.

CALEDONIA ST.

FOURTH ST.

THIRD ST.

SECOND ST.

FIRST ST.

SWINOMISH CHANNEL

LA CONNER

SWINOMISH CHANNEL

SWINOMISH CHANNEL

SWINOMISH CHANNEL

SWINOMISH CHANNEL

SWINOMISH CHANNEL

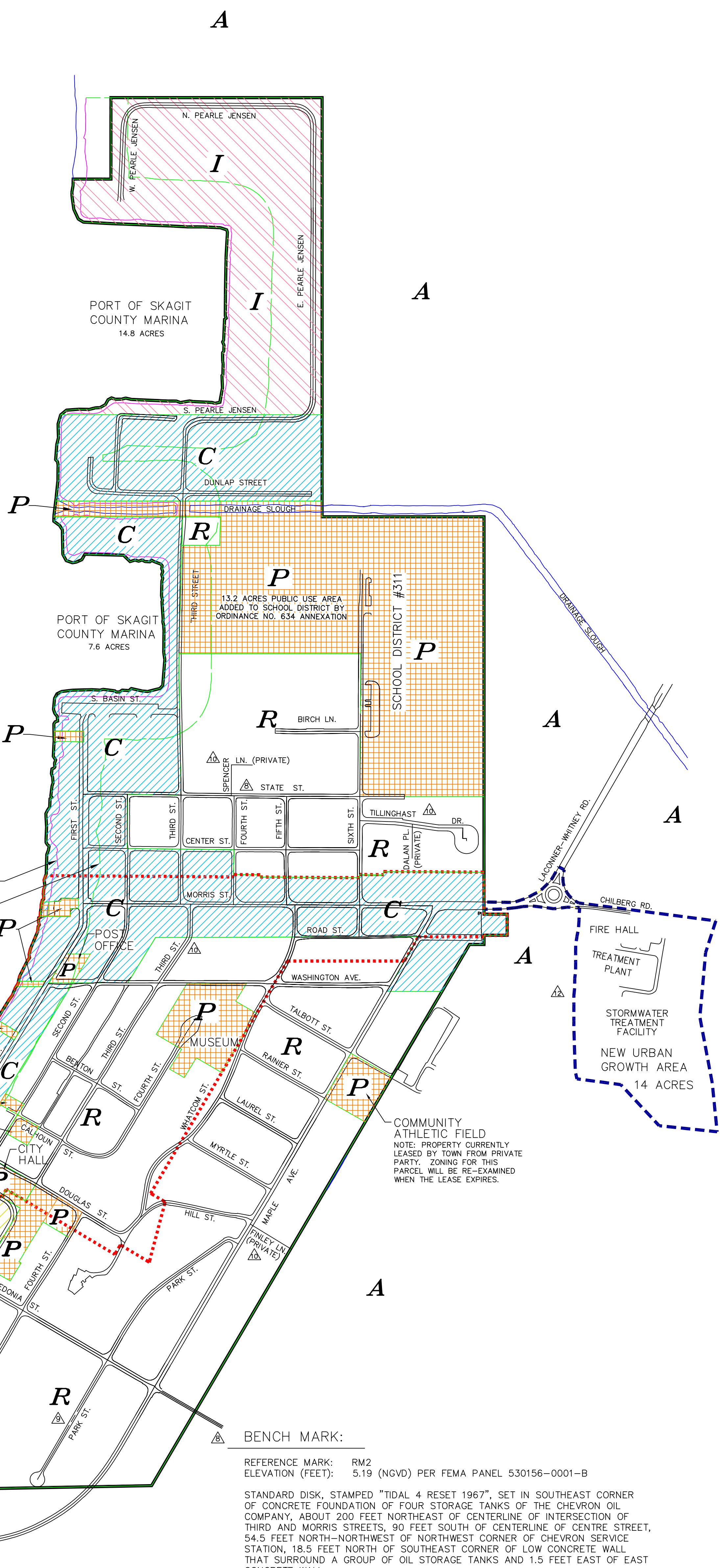

**BENCH MARK:**  
REFERENCE MARK: RM2  
ELEVATION (FEET): 5.19 (NGVD) PER FEMA PANEL 530156-0001-B  
STANDARD DISK, STAMPED "TIDAL 4 RESET 1967", SET IN SOUTHEAST CORNER OF CONCRETE FOUNDATION OF FOUR STORAGE TANKS OF THE CHEVRON OIL COMPANY, ABOUT 200 FEET NORTHEAST OF CENTERLINE OF INTERSECTION OF THIRD AND MORRIS STREETS, 90 FEET SOUTH OF CENTERLINE OF CENTRE STREET, 54.5 FEET NORTH-NORTHWEST OF NORTHWEST CORNER OF CHEVRON SERVICE STATION, 18.5 FEET NORTH OF SOUTHEAST CORNER OF LOW CONCRETE WALL THAT SURROUND A GROUP OF OIL STORAGE TANKS AND 1.5 FEET EAST OF EAST CONCRETE WALL.

NO.	DATE	DESCRIPTION	BY	APVD.
	12-13-07	INDUSTRIAL TO COMMERCIAL, DECREASE NEW URBAN GROWTH AREA	GS	GS
	11-2-05	GENERAL REVISIONS	GS	GS
	10-24-05	ADDITION OF S. THIRD ST., SPENCER & FINLEY LNS., TILLINGHAST DR., DALAN PL., EXTENSION OF STATE ST.	GS	GS
	9-26-05	REMOVAL OF S. 2ND & N. 4TH STREETS, EXTENSION OF PARK & 1ST STREETS REVS. TO LEGEND	GS	GS
	8-19-05	UPDATES TO ZONING, REVS TO AREA BREAKDOWN, CHANGES TO EHT, ELT ADDITION OF BENCHMARK INFO	GS	GS
	3-3-04	UPDATES TO ZONING, NEW URBAN GROWTH AREA, REVS TO AREA BREAKDOWN	GS	GS
	6-22-03	UPDATES TO ZONING	GS	GS
	2001	UPDATES TO MATCH CITY FILES	GS	GS
	10-30-95	ADD OHWM LINE, OHWM SETBACK LINE, MLLW LINE, ELT LINE AND EHT NOTE	SB	GS
	5-23-94	REV. GROWTH MANAGEMENT LIMITS AND PUBLIC USE AREAS	JA	GS
	7-2-93	REV. TOWN LIMITS TO INCLUDE ANNEXED PROPERTY PER ORDINANCE 634	JA	GS
	7-2-93	REV. TOWN LIMITS TO INCLUDE LOT PREVIOUSLY OMITTED	JA	GS

**STURDY ENGINEERING CORPORATION**  
Phone: (360) 299-2511 FAX: (360) 299-2698  
7168 San Juan Hill Lane, Anacortes, WA 98221

## TOWN OF LA CONNER ZONING MAP

PROJECT  
0108-04  
SHEET  
1 OF 1